



ASSEMBLY INSTRUCTION

etherCON® NE8MX6-T & NE8MX6-B-T CAT6A Cable Connector

- Tools:**
- HX-CAT6A or pliers wrench
 - Wire cutter
 - Cable pulling lubricant

- Cable O.D.:** 7.0 - 9.5 mm (0.28 - 0.37")
Wire Size: AWG 26/1 - AWG 24/1 (solid)
 AWG 27/7 - AWG 24/7 (stranded)
Insulation Diameter: > 0.85 - 1.1 mm (0.033 - 0.043")

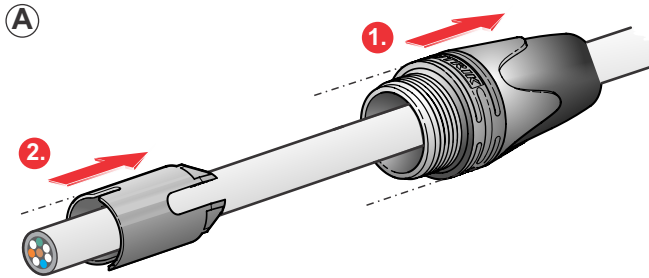

- A** Slide the boot (1.) and the chuck (2.) onto the cable.

To ease the boot assembly apply some cable pulling lubricant to the cable ends.

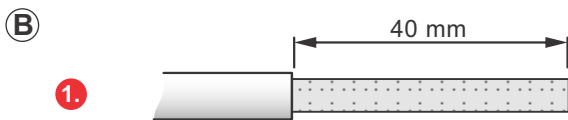

- B** 1. Prepare the cable as shown and strip the jacket at a length of 40 mm.

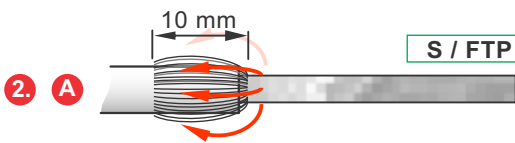

2. **A. S / FTP**
Cut off braided shield to approx 10 mm and fold the shield backwards.

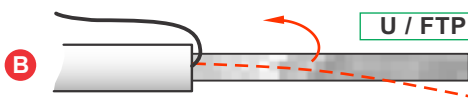

- B. U / FTP**
Remove the foil of the paired wires and bend back the drain wire for easier handling during assembly. Drain wire to be used for grounding.

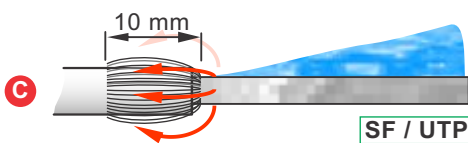

- C. SF / UTP**
Cut off braided shield to approx 10 mm and fold the shield backwards. Cut and remove the foil screen.

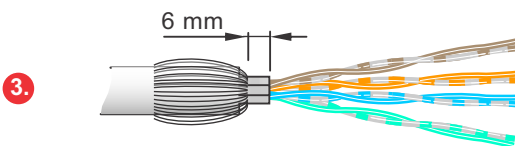

3. Remove the pair screening (if existing) to max. 6 mm.

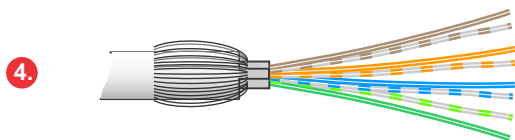

4. Presort and untwist the pairs as shown.

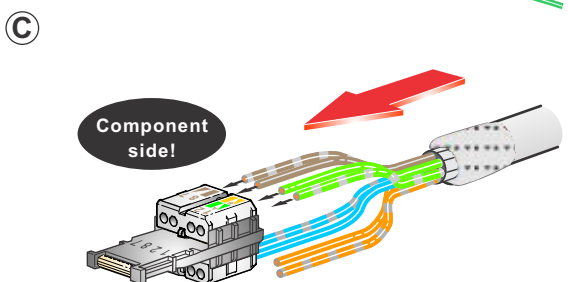

- C** Insert the wires into the designated position of the wire management as per below wiring scheme, either T568A or T568B

Component side!
1 2 8 7
3 6 4 5

Connection		RJ 45 PIN No.
Color code T568A	T568B	
W - G	W - O	1
G	O	2
W - O	W - G	3
BL	BL	4
W - BL	W - BL	5
O	G	6
W - BR	W - BR	7
BR	BR	8

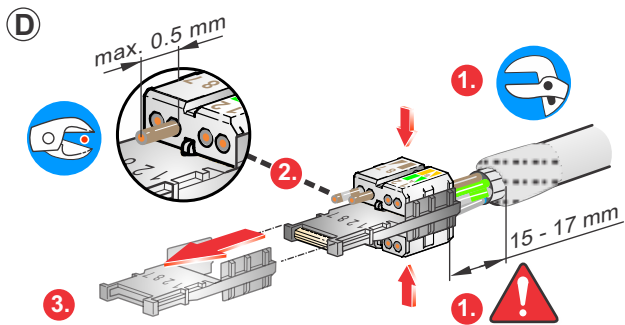

- D** 1. Use HX-CAT6A or pliers wrench to press the wire management together.

Attention:
Distance between the cable jacket and the wire management shall not exceed 15 - 17 mm (0.59" - 0.67").

Best return loss: < 15 mm

2. Cut all wires with a wire cutter. Allow wires to protrude max. 0.5 mm.
3. Remove the assembly guidance.

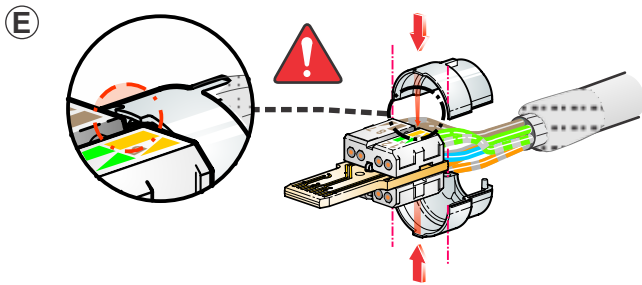

- E** Position the ground-shells over the wires as shown.

Attention:
Align the coding nibs of the ground shells to the grooves in between the wire pairs in the wire management.

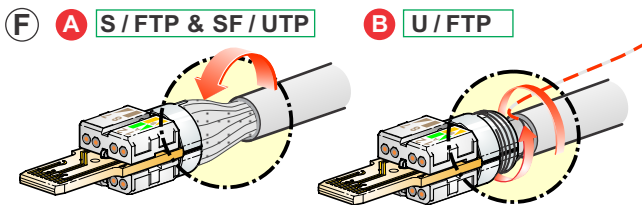

- F** A. Put the cable-shield over the ground shell and distribute the shield wires circumferentially.
- B. Put the drain wire over the ground shell and wrap the drain wire circumferentially.

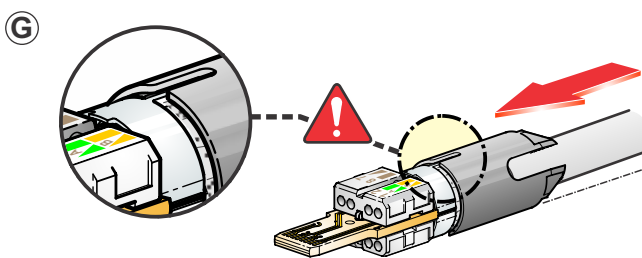

- G** Slide the chuck over the cable-shield / drain wire and the ground shell towards the end-position.

Attention:
Align the slots of the chuck to the ribs of the ground shell.

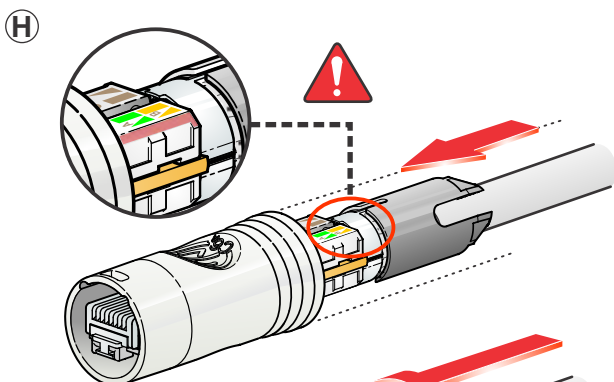

- H** Slide the pre assembled cable (step G) into the housing.

Attention:
Align the side of the wire management with wire numbers 1/2, 8/7 to the side of the housing that has the Neutrik logo and the slot.

Slide the gasket onto the chuck.

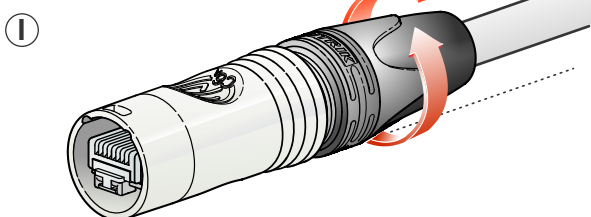

- I** Finish the installation by turning the bushing onto the connector.

Option:
Use the handtool HTXX-14 to tighten the bushing.



Draft. Nr.: BDA 462 V5
Update: 2025-09-02

Neutrik AG | LI-9494 Schaan

www.neutrik.com

Data subject to change without prior notice. © 2025 NEUTRIK®, NEUTRIK®, etherCON® are registered trademark of Neutrik AG. ALL RIGHTS RESERVED.